

CONNECTED ENGINES

SCANIA COMMUNICATOR



Requirements

Connected services from Scania require installation of the telematics unit Scania Communicator for data transfer as well as approval from the equipment user and a registered e-mail address. Accessing the data then requires a computer with Windows 7 (or higher), Google Chrome or Internet Explorer 7 (or higher), and a data transmission rate of >1 MB/s. If it is not already installed on your equipment, you can arrange an on-site retrofit appointment with the nearest Scania dealer.

Data storage and transfer

The unit transfers data when the ignition is on and there is coverage. If there is no coverage, the unit can store data up to 6 months. The collected data is transferred when there is coverage again.

Scania Communicator is a telematics unit kit which collects, stores and transfers engine data, to enable connected services from Scania. The kit consists of a control unit with bracket, a cable harness and an antenna. There is no operator interface on the unit. Scania Communicator is compatible with most telecom systems.

The collected data enables you to take control of your fleet and processes, maximizing uptime, improving maintenance planning and helping the workshop prepare for repairs.

System overview

- 1 Control unit with bracket
- 2 Antenna
- 3 Adapter cable
- 4 Cable harnesses
- 5 Coaxial cable 2.7 m

The cable harness (4) can be selected with a length of 4.5 or 6.0 m. For marine engines as well as EU Stage V industrial and power generation engines, 3.0 m length is also available.

The system can also be ordered with connector kits for the control unit and the antenna to enable more flexible connection. When selecting this option, cable harness 4 and coaxial cable 5 are not provided.

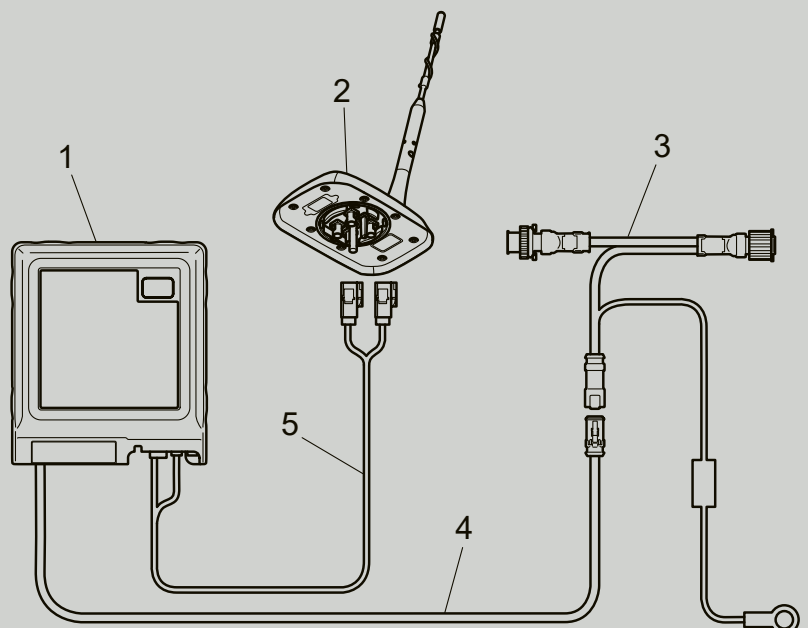

Control unit and bracket

The control unit is delivered with a bracket. It should be placed in a casing that protects against dust and moisture and fulfils IP52.

Weight control unit: approx. 400 g.
Weight bracket: approx. 200 g.

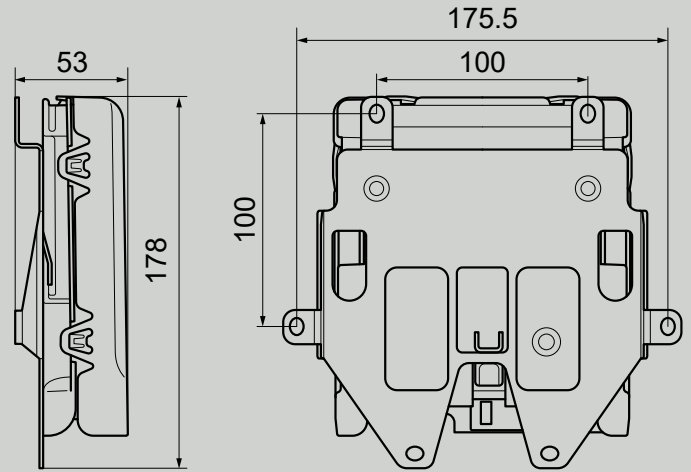

Antenna

The antenna is connected to the control unit with a 2.7 m coaxial cable. The antenna should be placed externally on a flat horizontal surface.

Weight: approx. 250 g.

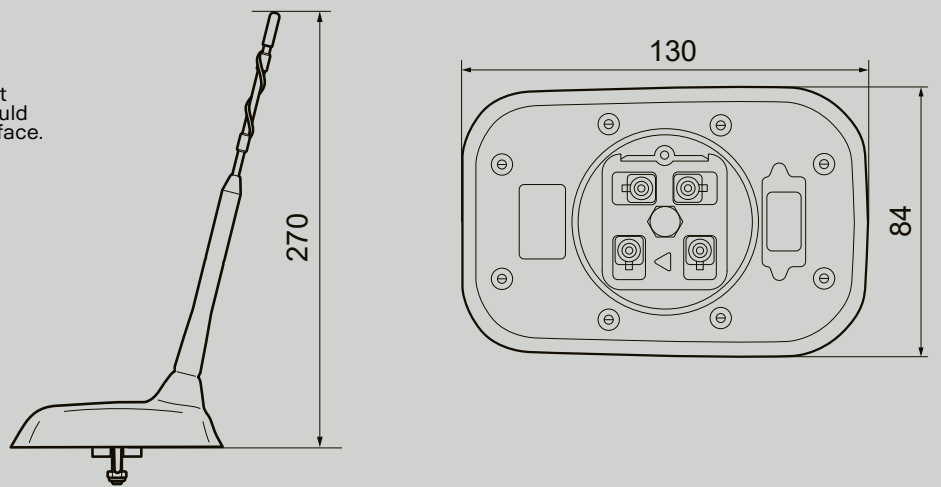

Hardware versions

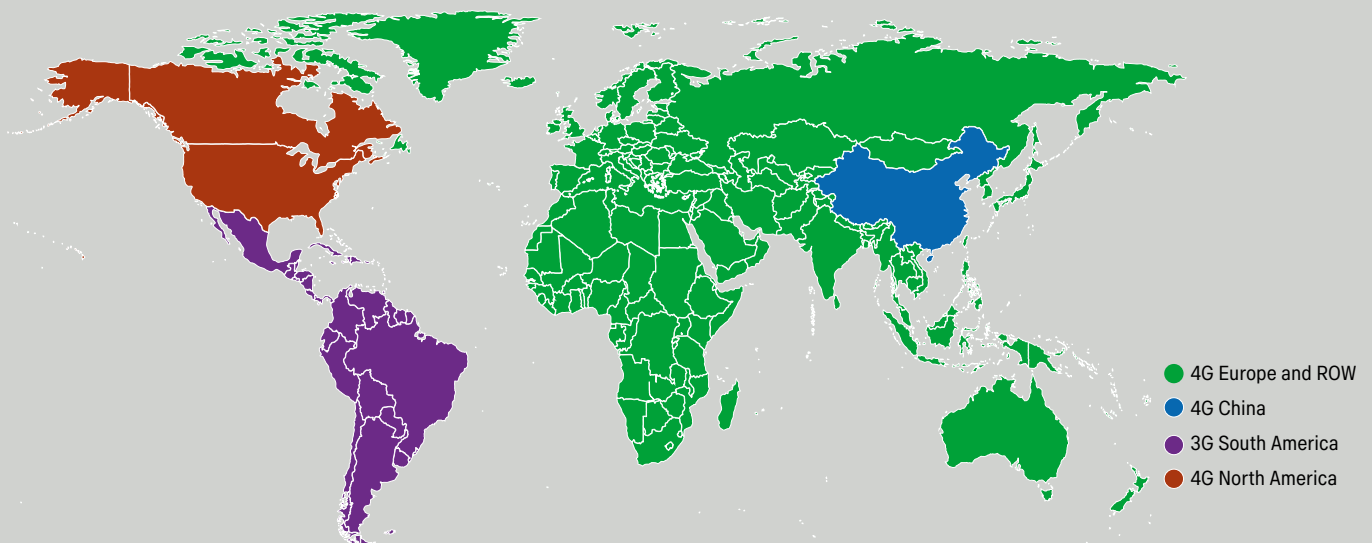

There are four different hardware versions depending on the network standard in the world. Hardware version should be selected based on the final destination of the engine.